

HELP BUILD THE CHILDREN'S PLAY SPACE – BUY A BRICK TODAY!

ROTARY'S 100 YEARS OF SERVICE

The State College Rotary Clubs, in conjunction with Rotary International, are celebrating 100 years of community service in 2005. To commemorate this centennial, the State College Rotary Clubs have chosen a community project that will attract and stimulate the youngest segment of our population, namely, 2-8 year olds, by constructing a unique play area in Central Parklet in downtown State College.

Why Central Parklet?

In 1994, State College Borough completed a renovation project in Central Parklet that included the addition of lights, benches, walkways, stage and landscaping. Unfortunately, funds fell short to enable the renovation of the "tot lot" in the northwest corner of the park. In 2003, the State College Rotary Clubs received approval from the Borough Council to help reconstruct the tot play area, as well as adding other park improvements pertaining to young children, in celebration of Rotary International's 2005 centennial.

What is the Concept?

This past year, Rotary received the assistance of Jones and Battaglia Landscape Architects for the design and layout of a unique child space within the northern end of the park. Included in this children's space will be



renovated stepping-stones and sand pit, a children's village, climbing wall, miniature benches, a "babbling brook", and miniature sculptures, all connected by a children's path.

What are the Project Details?

The proposed project will cost approximately \$50,000, of which one-half is to be raised by the Rotary Clubs, with the Borough contributing the remaining funds. Part of the Children's path will be a recognition and celebration of children. This portion of the walkway will be constructed of bricks, which will contain the first names of children.

Bricks will be numbered and referenced on a "Certificate of Participation" for identification purposes. Brick orders can also be clustered into family groups.

How Can You Help?

You can be a part of the celebration by purchasing a brick inscribed with the first name of your children, grandchildren, or other special little ones. Their name will become a permanent part of Central Parklet, preserving their childhood. Imagine that even in their adult years, they will realize that you thought enough of them to celebrate their name in a special place constructed for generations of children's enjoyment.



How Much Do the Bricks Cost?

You can purchase your first brick for \$100, and each subsequent brick for \$50 each.

How Do I Buy Bricks?

You may purchase bricks by filling out the attached form and sending it in to the address indicated. A "Certificate of Participation" will be sent to you, as well as acknowledgement of your tax-deductible contribution toward this project.

Be a part of Our Celebration

Buy a Brick Today!

Please fill in your information on the other side of this form.



Or

Make a donation to Our Project

I wish to make a donation of \$ _____

Please make check payable to:

State College-Downtown Rotary Foundation

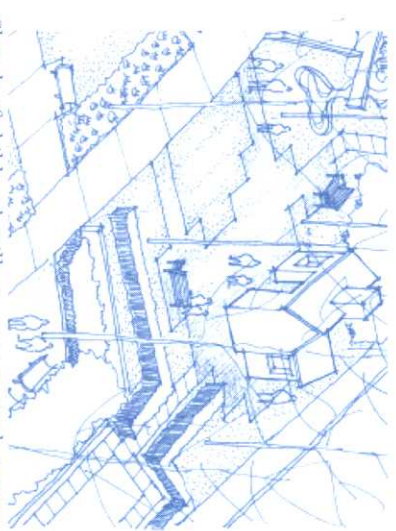

Sketch of children's village; area around structure is where bricks will be placed

Whether you are purchasing a brick or making a donation, please fill out your name and address on the reverse side of this form, detach, and mail to the address indicated. Brick purchases and donations are tax deductible under provisions of 501(c)(3) contributions.

